

# WI

## Displacement transducer

### Special features

- Short overall length
- Shaft diameter 8 mm
- Protection class IP67
- Good price/performance ratio



Dimensions (in mm; 1 mm= 0.03937 inches)

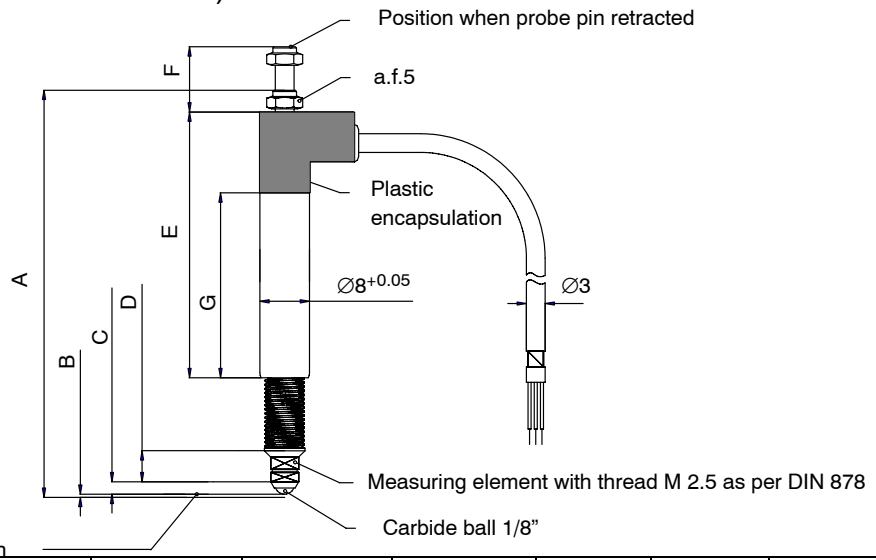

Type	A	B	C	D	E	F	G
WI/2mm-T	65.5	0.5	2	5	42.75	10.5	29.75
WI/5mm-T	79.5	0.5	5	2.5	55.8	11	41.8
WI/10mm-T	95	0.5	10	1.5	64.8	15	51.8

## Specifications

Transducer type		WI/2mm-T	WI/5mm-T	WI/10mm-T
<b>Nominal (rated) displacement (nominal (rated) measuring span)</b>	mm	2	5	10
<b>Nominal (rated) output span</b> (between starting point and end point when output is not under load)	mV/V	80	80	80
<b>Nominal (rated) signal</b> at starting point	mV/V	-40		
<b>Nominal (rated) signal</b> at end point	mV/V	40		
<b>Nominal (rated) output span tolerance</b>	%	± 1		
<b>Zero signal</b>		The output signal is zero when the plunger or the probe is located in mid measuring range		
<b>Zero signal setting tolerance</b>	mV/V	± 4		
<b>Linearity deviation</b> (max. deviation between starting point and end point (including hysteresis))	%	± 0.2		
<b>Nominal (rated) temperature range</b>	°C	10 ... 60		
<b>Operating temperature range</b>	°C	-20 ... +80		
<b>Temperature effect in the nominal (rated) temperature range</b> on the zero signal, related to the nominal output span per 10 K	%	± 0.1	± 0.1	± 0.1
on the nominal (rated) output span related to the actual value per 10 K	%	± 0.2	± 0.2	± 0.2
<b>Weight</b> of measuring element without connection cables	g	12	15	20
of moving parts	g	4.25	4.8	5.5
<b>Amount of input impedance</b>	Ω	27	42	45
<b>Nominal (rated) excitation voltage</b> (effective)	V <sub>eff</sub>	2.5		
<b>Operating range of excitation voltage</b>	V <sub>eff</sub>	0.5 ... 10		
<b>Carrier frequency</b>	Hz	4800 ± 8%		
<b>Degree of protection as per EN 60529</b> for transducer duct and core channel	-	IP67		
<b>Surface materials</b>	-	rustproof		
<b>Load capacity with vibration</b> sinusoidal DIN40046/8 IEC Part 2-6 (type-tested) Frequency range	Hz	5 to 65		
Vibration acceleration	m/s <sup>2</sup>	150		
Duration (per direction)	h	0.5		
<b>Load capacity with mechanical shock</b> Sheet 26 (type-tested) Number of impacts (per direction)	-	1000		
Impact acceleration	m/s <sup>2</sup>	650		
Impact duration	ms	3		
Impact form	-	Half sine wave		
<b>Spring constant</b>	N/mm	0.1	0.04	0.08
<b>Spring force at starting point</b>	N	0.8		
<b>Spring force at end point</b>	N	1	1	1.6
<b>Max. permissible acceleration</b> of probe tip and plunger, approx.	m/s <sup>2</sup>	180	160	140
<b>Cut-off frequency</b> of probe tip at ± 1 mm stroke, approx.	Hz	68	64	60
at maximum stroke, approx.	Hz	68	45	27
<b>Cable length</b> , approx.	m	3		
<b>Cable type</b>	-	PU black		

### Accessory:

Assembly set, mounting block 8 mm, tool

Order no.: 1-WZB8

Hottinger Baldwin Messtechnik GmbH

Modifications reserved.

All details describe our products in general form only. They are not to be understood as express warranty and do not constitute any liability whatsoever.

Im Tiefen See 45, D-64293 Darmstadt, Germany

Tel.: +49 6151 8030; Fax: +49 6151 803 9100

E-mail: support@hbm.com www.hbm.com



measurement with confidence